

All installations should be done by a certified electrician

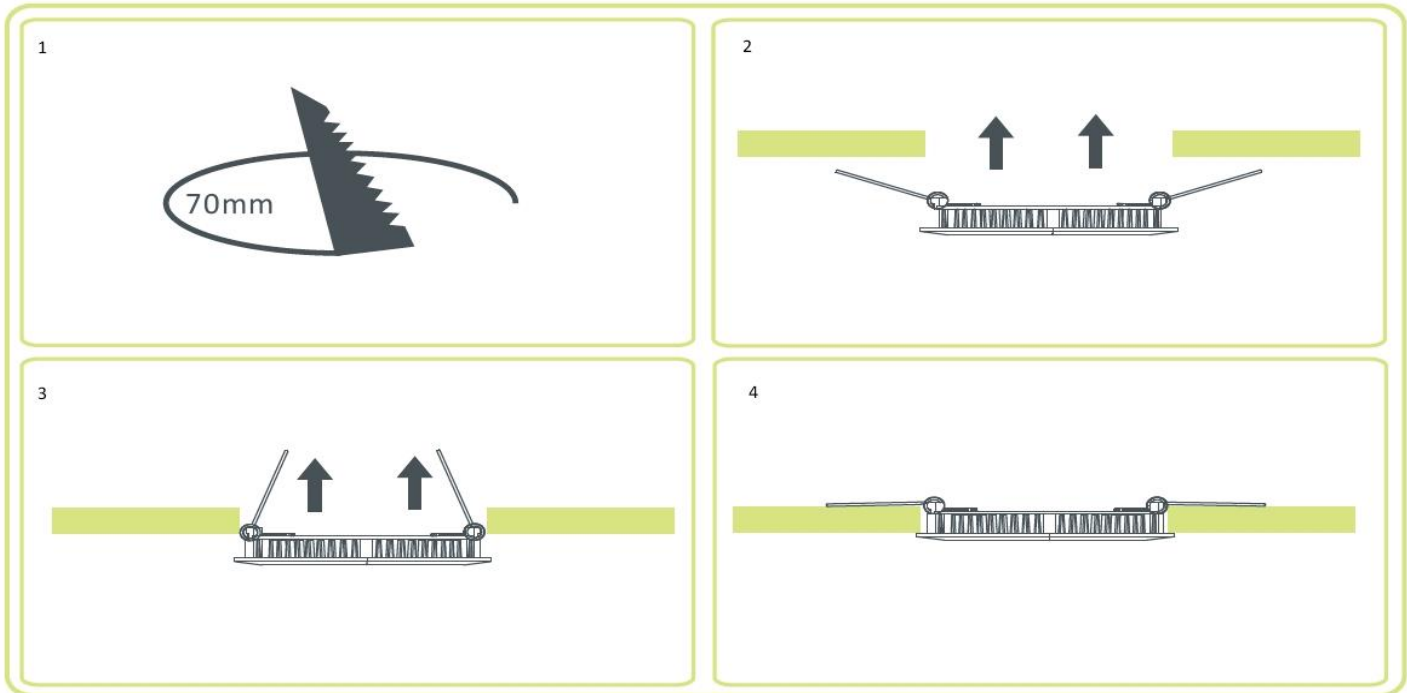

Installation Instructions

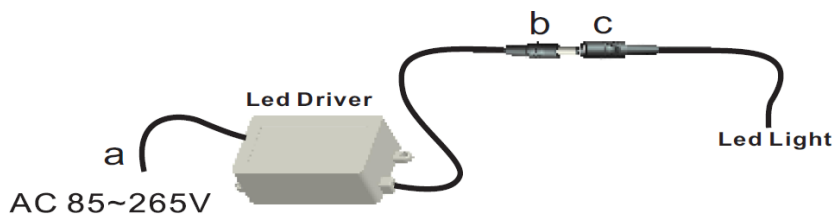

Before connecting and powering the lamp, please ensure that:

1. All Power is off.
2. The led light is connected to the driver. Marry the male and female pins (b&c) as shown above.
3. The driver is connected to AC 100–240V. Connect point A to ac power (100~240V) and ensure the connection is secure.
4. Install the lamp as shown in the installation drawing.
5. Check the entire circuit and ensure that all is perfect.

Warnings !

To avoid the risk of electric shock, do not attempt to open the power supply.

In order to avoid the risk of fire , use only the power supply included in the kit with LED panels